

**LOCATION PLAN**  
1:1250

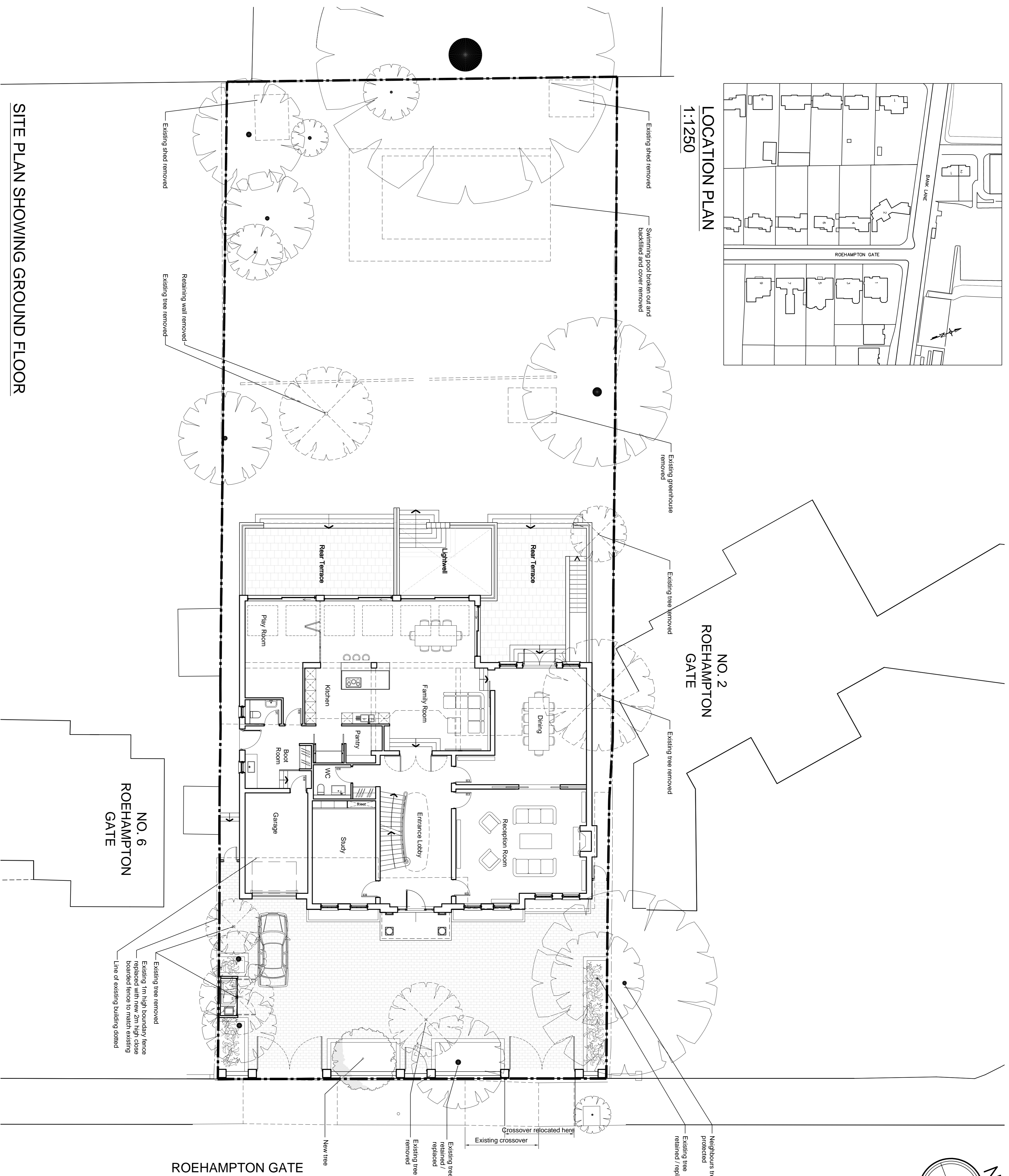

**NO. 2  
ROEHAMPTON  
GATE**

**NO. 6  
ROEHAMPTON  
GATE**

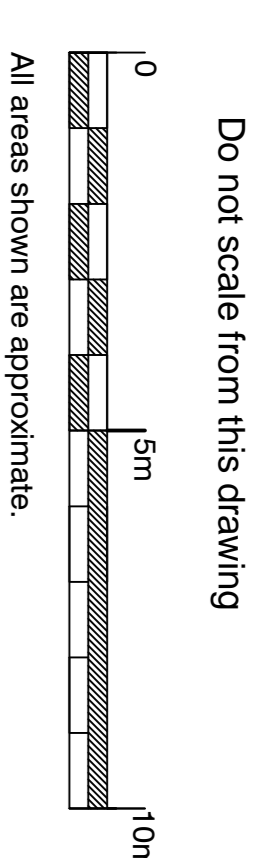
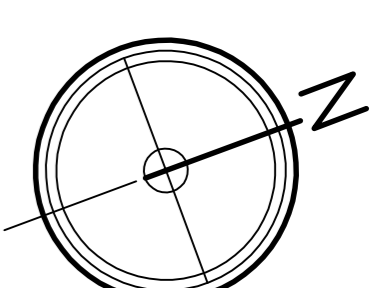

Do not scale from this drawing

**SUMMARY OF SURFACE WATER DRAINAGE STRATEGY**

The handling and disposal of Surface (rain / storm) water is proposed to be subdivided into two sections

To the rear of the house:  
The rainwater from the roof and terrace level gutters are collected via downpipes which feed via underground surface water drains, into a subterranean harvesting tank located beneath the rear garden area. This also collects feeds from inset gutters within the paved areas (all lead to falls). This is run under gravity fall to the collection tank (via filters) for storage which is then pumped to permeable pavers. The potential overflow from the permeable pavers is collected via drains set beneath the raised lawn areas.

To the front of the house:  
The rainwater from the roof level gutters are collected via downpipes which feed via underground surface water drains into the existing Surface Water Manhole with final connection as existing into the Public Surface Water Sewer. A continuous slot drainage channel proposed to be incorporated into the front paved hardstanding to collect storm and rainwater run off which will flow under the natural gradient fall towards the highway. Any serious storm water overflow will drain as existing into the highway.

In this way potentially 50% of the surface water run-off is handled by a moderated SUDS system, reducing the discharge to the public sewer from the existing condition.

In both instances above the surface water drainage is maintained separately from the Foul Water drainage system which discharges into the existing Public Foul Water Sewer via a dedicated manhole as existing. Final manholes and sewer connections to be inspected post demolition and repaired / replaced as necessary.

**PLANNING**

Revision	Client	Project
	4 ROEHAMPTON GATE LLP	4 ROEHAMPTON GATE
		LONDON, SW15 5JS

**PROPOSED GENERAL ARRANGEMENT OS AND SITE PLAN**

Scale	Date	Drawn
1:100@A1	Oct 2010	CH/CW

**PAUL BROOKES ARCHITECTS**

The Works 28 Barnes Avenue London SW13 9AB

T 020 8663 0181  
F 020 8663 0763  
E pbb@pbworks.co.uk

Drawing No 4230 | D [ ] 20

**SITE PLAN SHOWING GROUND FLOOR**