

Do not scale from this drawing.
All dimensions to be checked on site before work commences.
Copyright reserved.

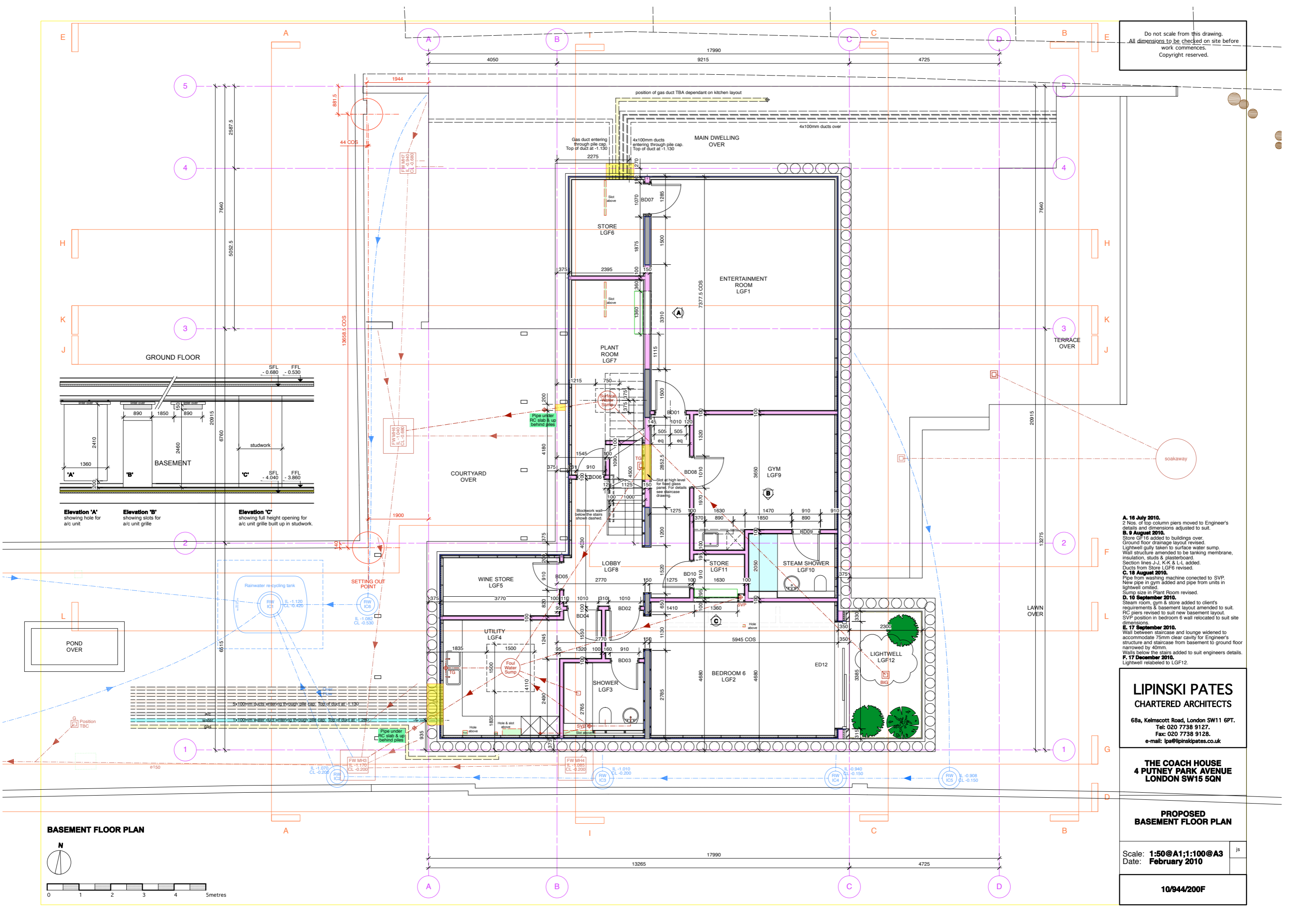

- A. 16 July 2010.**
2 Nos. of top column piers moved to Engineer's details and dimensions adjusted to suit.
- B. 9 August 2010.**
Store GF-16 added to buildings over. Ground floor drainage layout revised. Lightwell gully taken to surface water sump. Wall structure amended to be tanking membrane, insulation, studs & plasterboard. Section lines J-J, K-K & L-L added. Ducts from Store LGF6 revised.
- C. 18 August 2010.**
Pipe from washing machine connected to SVP. New pipe in gym added and pipe from units in lightwell omitted. Sump size in Plant Room revised.
- D. 10 September 2010.**
Steam room, gym & store added to client's requirements & basement layout amended to suit. RC piers revised to suit new basement layout. SVP position in bedroom 6 wall relocated to suit site dimensions.
- E. 17 September 2010.**
Wall between staircase and lounge widened to accommodate 75mm clear cavity for Engineer's structure and staircase from basement to ground floor narrowed by 40mm. Walls below the stairs added to suit engineers details.
- F. 17 December 2010.**
Lightwell relabelled to LGF12.

LIPINSKI PATES
CHARTERED ARCHITECTS
68a, Keilmoscott Road, London SW11 6PT.
Tel: 020 7738 9127.
Fax: 020 7738 9128.
e-mail: lpa@lipinskিপates.co.uk

THE COACH HOUSE
4 PUTNEY PARK AVENUE
LONDON SW15 5QN

PROPOSED
BASEMENT FLOOR PLAN

Scale: **1:50@A1;1:100@A3**
Date: **February 2010**

10/944/200F

BASEMENT FLOOR PLAN

